

# LEGENDA

Specifikacija sadnog materijala

-  Bamboo
-  Photinia
-  Magnolia - zimzelena
-  Aucuba japonica
-  Hortenzija
-  Cupressocyparis leylandii
-  Hedera helix
-  Staza - cigle
-  Travnjak
-  Malč
-  Vinca minor



Bamboo



Photinia



Magnolia - zimzelena

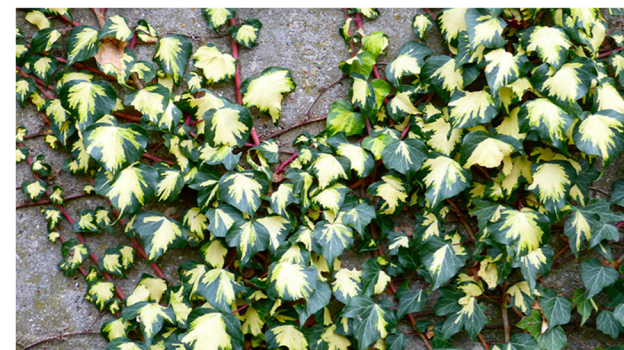

Hedera helix



Aucuba japonica



Hortenzija



Cupressocyparis leylandii

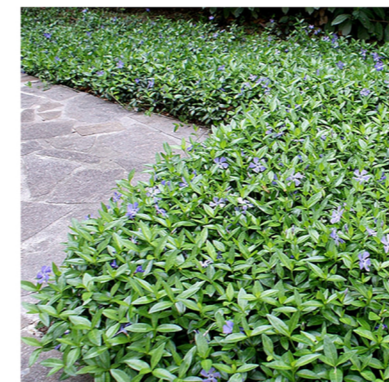

Vinca minor



Photinia



Echinacea angustifolia



Spiraea japonica 'Little Princess'

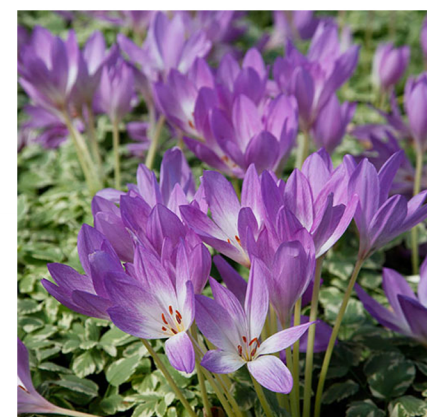

Colchicum autumnale

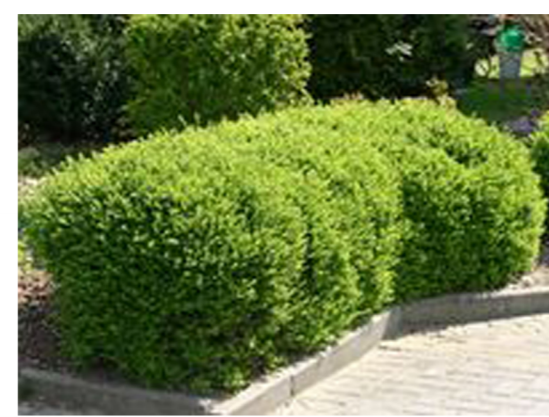

Lonicera nitida



Spiraea x vanhouttei



Cornus kousa

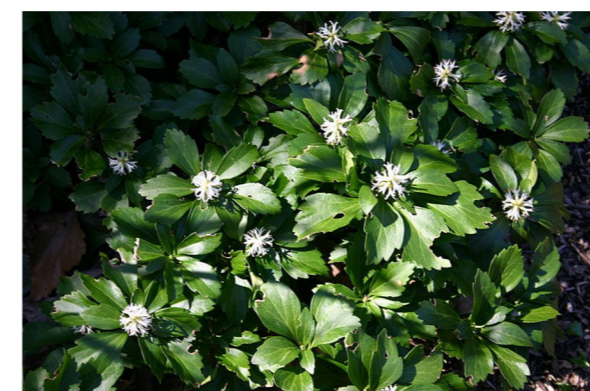

Pachysandra terminalis

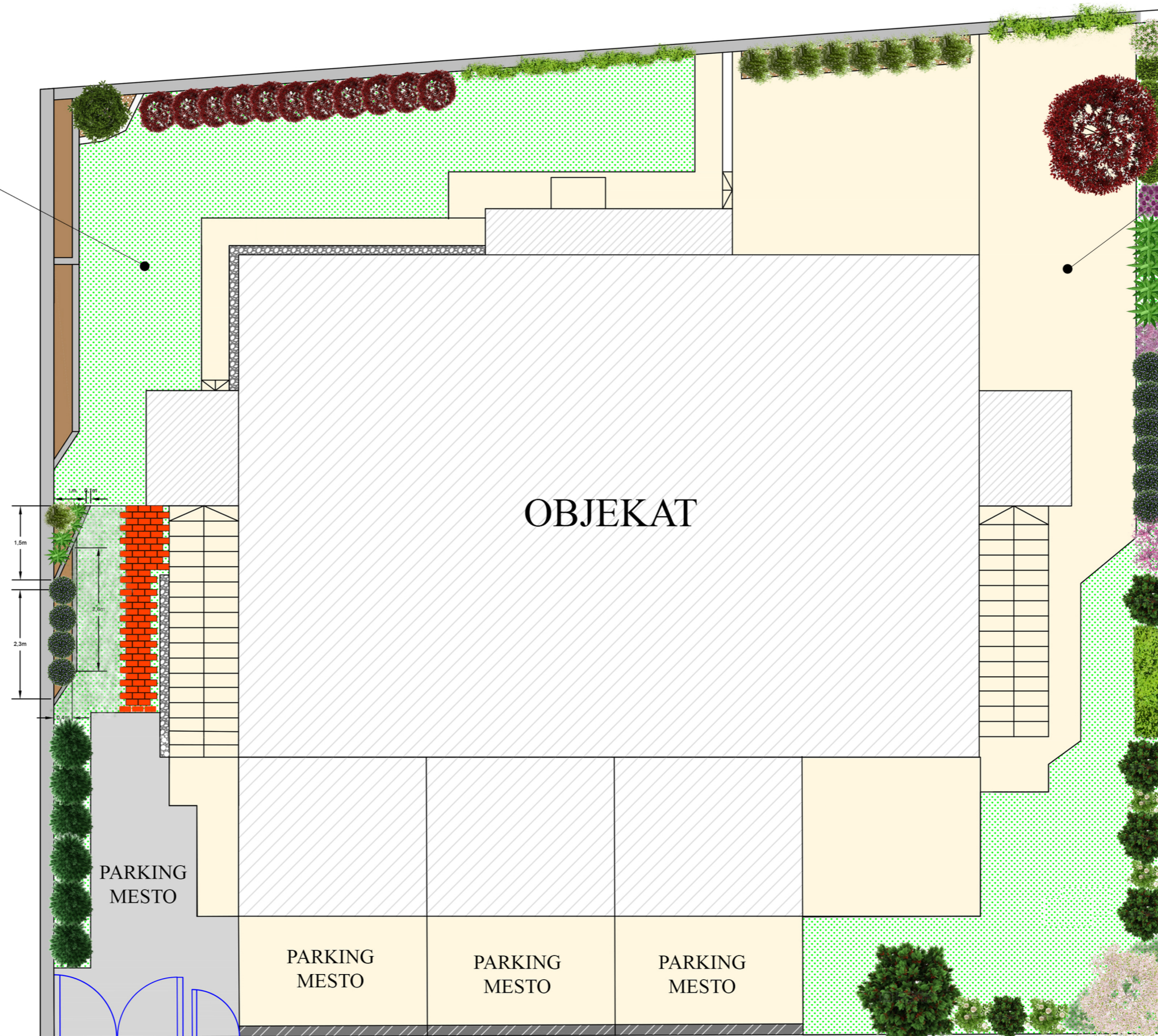

# LEGENDA

Specifikacija sadnog materijala

-  Philadelphus coronarius
-  Prunus laurocerasus
-  Photinia
-  Aucuba japonica
-  Hortenzija
-  Echinacea angustifolia
-  Spiraea japonica 'Little Princess'
-  Colchicum autumnale
-  Lonicera nitida
-  Hedera helix
-  Spiraea x vanhouttei
-  Cornus kousa
-  Postojeće zelenilo
-  Travnjak
-  Pachysandra terminalis



Philadelphus coronarius



Prunus laurocerasus

